



17 Eldon Park

London, SE25 4JQ

£1,650 Per Month

Galloways are delighted to market this superb two double bedroom raised ground floor period conversion flat. The property has just been fully renovated throughout and comes with a modern fitted kitchen and appliances, a contemporary fitted bathroom, a lounge with Juliette balcony and wood flooring, high ceilings, double glazed windows, and central heating. Situated just a few minute's walk from South Norwood High Street and Norwood Junction train station. Also close by is the popular South Norwood Country Park.

Croydon Council Tax Band C £1747.00p.a

Viewing

Please contact our Galloways Penge Office on 020 8778 1120 if you wish to arrange a viewing appointment for this property or require further information.

- TWO DOUBLE BEDROOMS
- ATTRACTIVE BUILDING
- MODERN FITTED KITCHEN
- STYLISH BATHROOM SUITE
- JULIETTE STYLE BALCONY
- HIGH CEILINGS
- CENTRAL HEATING
- DOUBLE GLAZING
- 8 MINUTE WALK TO NORWOOD JUNCTION STATION
- (WALKING TIMES ESTIMATED BY GOOGLE MAPS)



2



1



1



D

Floor Plan

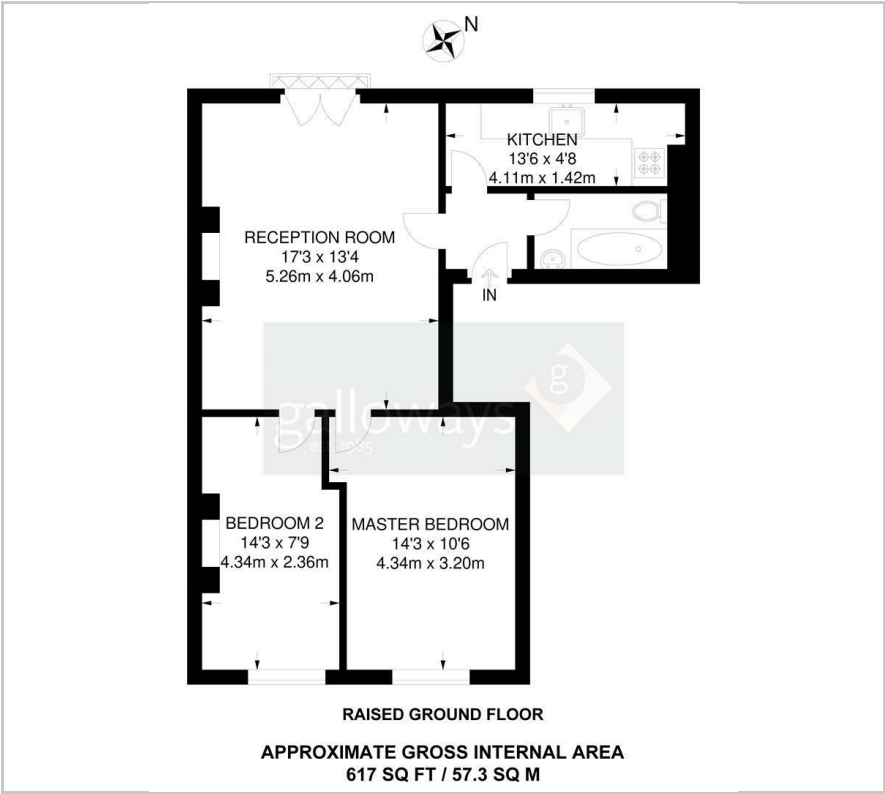

Area Map



Energy Efficiency Graph

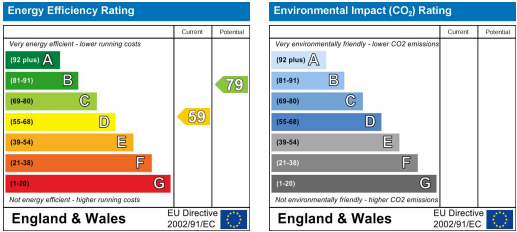

These particulars, whilst believed to be accurate are set out as a general outline only for guidance and do not constitute any part of an offer or contract. Intending purchasers should not rely on them as statements of representation of fact, but must satisfy themselves by inspection or otherwise as to their accuracy. No person in this firms employment has the authority to make or give any representation or warranty in respect of the property.